

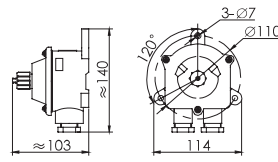

CXD8

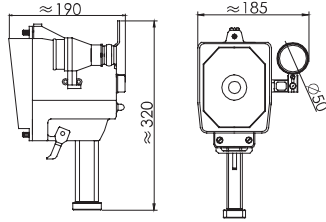

插座 SocketCXZ8

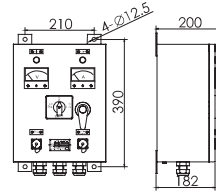

充电箱 Charger box



电池箱 Battery box



插座 SocketCXZ8-1

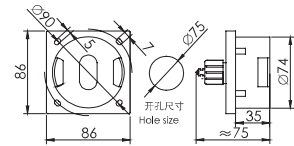
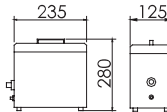

■ The scope of application:

This light fits for daylight signal communication between the ships above 150T.

■ Products feature:

- 1.The shell is made of high quality cast aluminum by mold pressing.
- 2.With mechanical flash device.
- 3.Light weight, convenient to operate and bring.
- 4.It can be equipped with charger and battery box additionally.
- 5.Cable outside diameter  $\varnothing 9\text{mm}$ .

■ Adopt standard and products certification:

- 1.Conform to <<MSC.95(72)resolution >>.
- 2.Approved by type approval of China Classification Society(CCS).

■ 适用范围：

该灯具可作为 150T 以上各类船舶之间白昼灯光信号联络之用。

■ 产品特性：

1. 外壳采用优质铸铝，用模具压制成型。
2. 配有机械闪光装置。
3. 重量轻，操作和携带方便。
4. 可另配充电箱和电池箱及插座。
5. 电缆外径  $\varnothing 9\text{mm}$ 。

■ 采用标准及产品认证：

1. 符合《MSC.95(72) 决议》。
2. 通过中国船级社 (CCS) 型式认可。

CXD8 白昼信号灯 Daylight signal light	
光柱角 Light pillar angle	6°
光强 Light intensity	60,000cd
望远镜倍率 Telescope magnification	4
望远镜视角 Telescope visual angle	3°
可见距离 Visibility	> 2n.m
电压 Voltage/ 功率 Power	24V/60W
灯座 Lamp holder	G6.35
插头 Plug	P20- 四芯 four pin
防护等级 Protection class	IP44
重量 Weight	7.5kg

CXD8-CDX 充电箱 Charger	
输入 Input	AC110V/60Hz AC220V/50Hz/60Hz
输出 Output	AC24V、DC24V
容量 Capacity	7Ah
使用温度 Temperature	-25℃ ~ 45℃
插座 Socket	P20- 四芯 four pin
防护等级 Protection class	IP56
重量 Weight	9.6kg